

DISTRICT LANDS OFFICE  
TUEN MUN  
LANDS DEPARTMENT



-----  
Signed by the Tenant / Sealed with the  
Common Seal of the Tenant and signed by  
  
in the presence of  
  
-----

-----  
Executed by the Tenant acting through  
( ), its sole director/  
( ), its director and  
( ), its director/  
( ), its director and  
( ), its company secretary  
in accordance with section 127(3) and 127(5)  
of the Companies Ordinance (Cap. 622)  
  
in the presence of  
  
-----

-----  
District Lands Officer, Tuen Mun  
  
-----

-----  
Witness to the Signature of  
District Lands Officer, Tuen Mun  
  
-----

Dated this \_\_\_ day of \_\_\_ 20\_\_

LOCATION

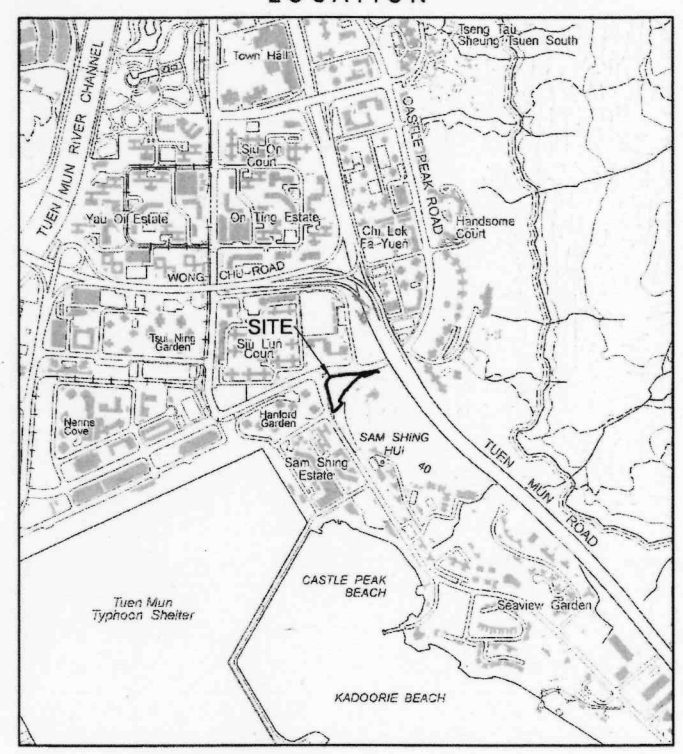

SCALE 1:20 000

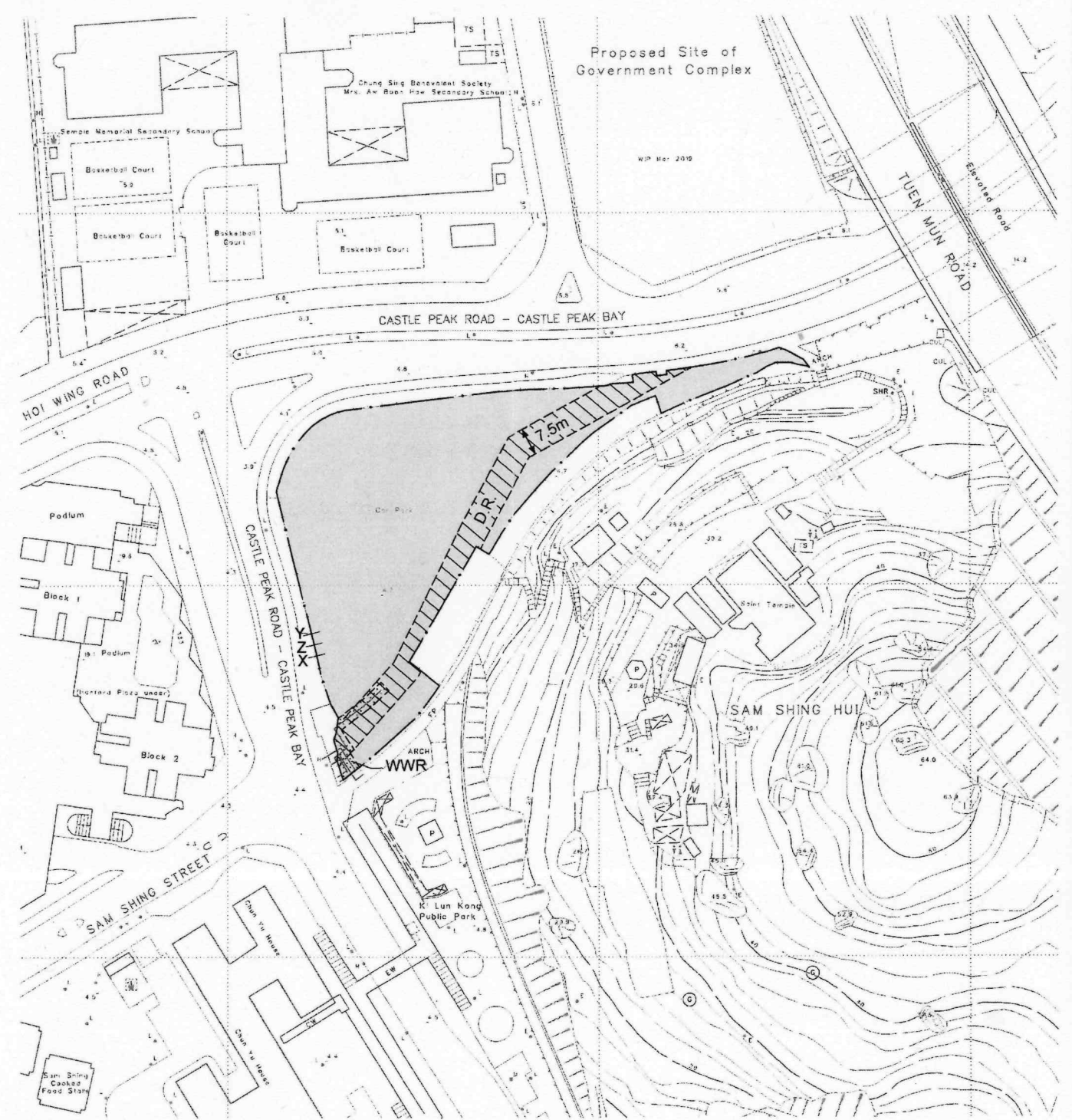

COLOURED PINK, PINK HATCHED BLACK, PINK HATCHED BLACK STIPPLED BLACK AND  
PINK STIPPLED BLACK AREA 4 930 SQUARE METRES (ABOUT)

SCALE 1:1 500

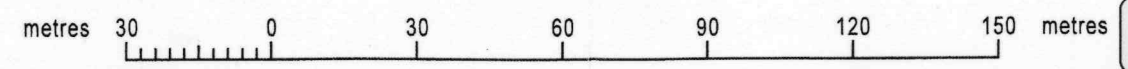

**DRAFT**

FOR IDENTIFICATION PURPOSES ONLY  
 District Lands Office, Tuen Mun  
Lands Department  
Plan Prepared by District Survey Office, Tuen Mun  
© Copyright reserved - Hong Kong SAR Government

SHORT TERM TENANCY No. MX19005

File No. L/M(1) to DLOTM 10/MAT/19 & LD DSO/TM/W 2016/68
Survey Sheet No. 6-SW-11B
Layout Plan No. -----
Reference Plan No. -----
PLAN No. TMM4133

Date : 14/05/2019