

位置 LOCATION

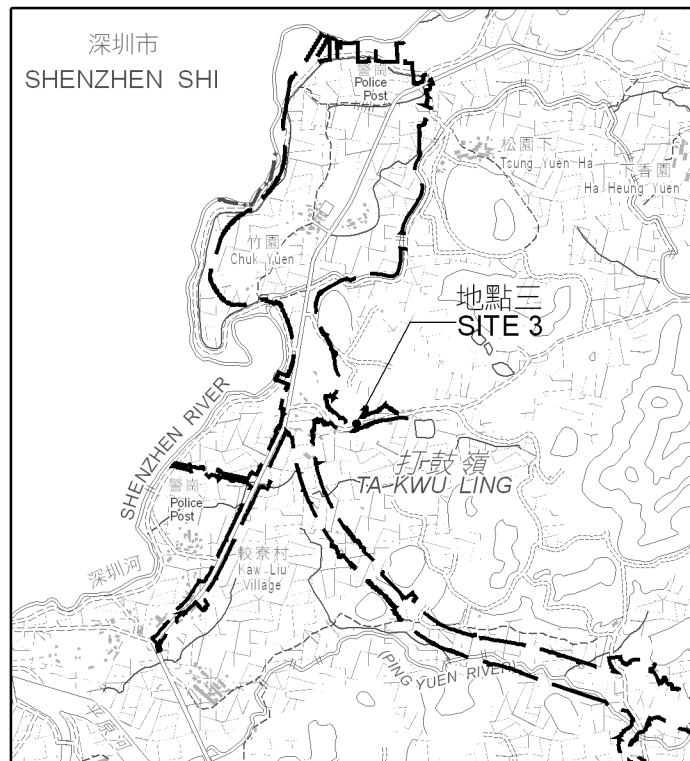

比例 SCALE 1:20000

圖例 LEGEND

- 施工區界限  
LIMITS OF WORKS AREA
- 將予徵用的土地  
LAND TO BE ACQUIRED
- 紅色  
RED

將予徵用土地的面積

AREA OF LAND TO BE ACQUIRED

地點編號 SITE No.	墳墓編號 GRAVE No.	平方米 (約數) m <sup>2</sup> (ABOUT)
地點三 SITE 3	AG3	15.4

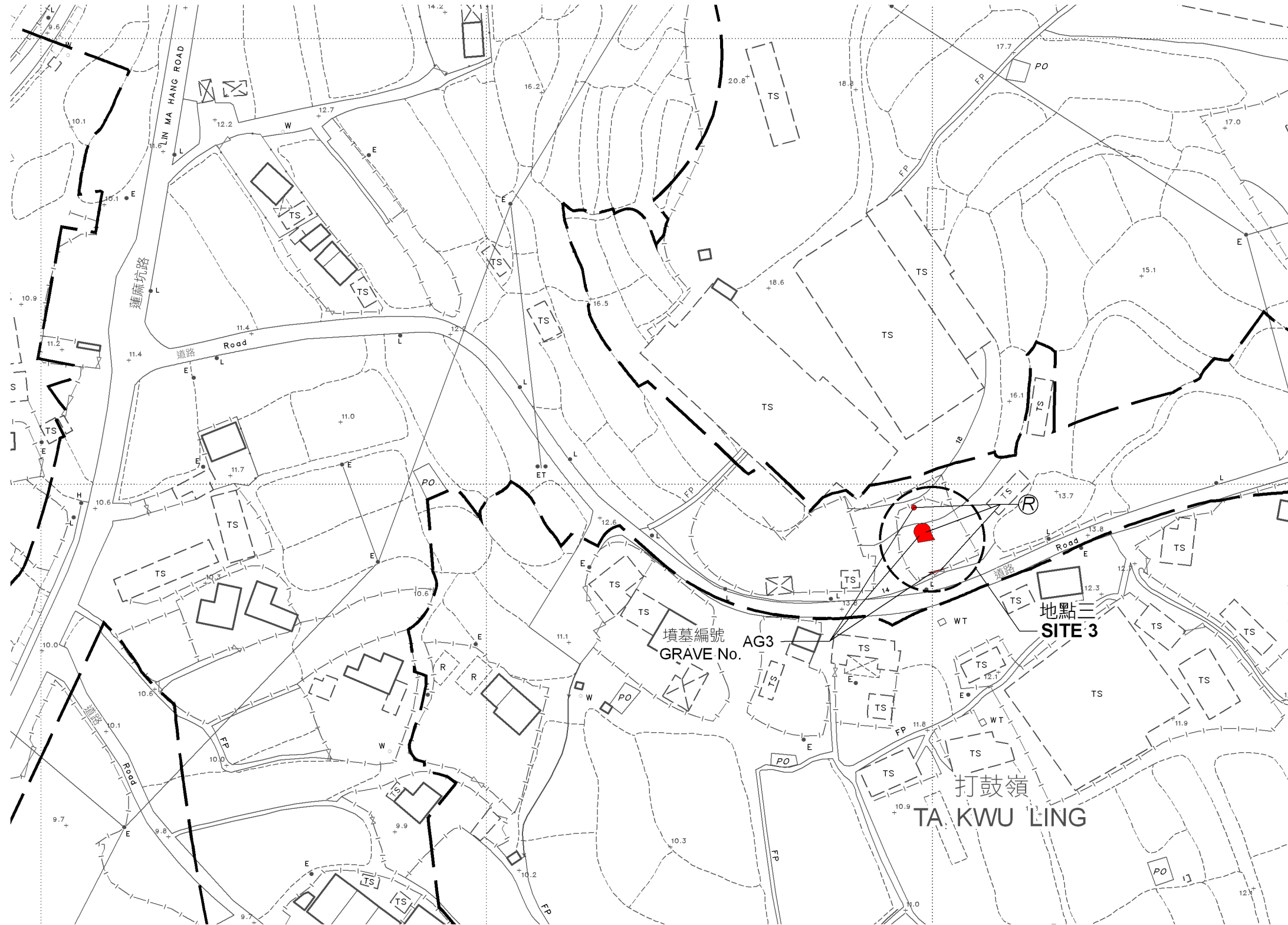

比例尺 SCALE 1:1000

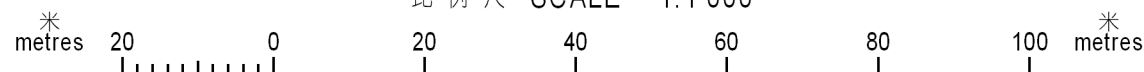

只作識別用  
FOR IDENTIFICATION PURPOSES ONLY

Signed

( 蔣翠雲 Ms Sophia CHIANG )  
北區地政專員 District Lands Officer, North  
日期 Date 02/05/2012

地政總署 北區地政處  
District Lands Office, North  
Lands Department

圖則由北區測量處繪製  
Plan Prepared by District Survey Office, North

© 香港特別行政區政府 一版備所有 Copyright reserved - Hong Kong SAR Government

土地徵用圖則  
土地徵用(管有業權)條例(第130章)  
徵用土地以進行  
蓮塘/香園圍口岸與相關工程計劃

LAND ACQUISITION PLAN  
LAND ACQUISITION (POSSESSORY TITLE) ORDINANCE (CHAPTER 130)  
ACQUISITION OF LAND FOR THE IMPLEMENTATION OF  
LIANTANG / HEUNG YUEN WAI BOUNDARY CONTROL POINT AND ASSOCIATED WORKS PROJECT

檔案編號 File No. L/M(2) in DLON 3/27/09

測量圖編號 Survey Sheet No. 3-NW-13B

參考圖編號 Ref. Plan No. 255228/GZP/1000A, 1001A, 1002A, 1003, 1004A, 1005, 1006, 1007A, 1008A, 1009, 1010A, 1011, 1012A, 1013, 1014A, 1015A, 1016A AND 1017A (土木工程拓展署) (CEDD)

圖則編號 PLAN No. DNM2595a (第三張 共九張) (Sheet 3 of 9)

日期 Date : 06/03/2012