



**Information Sheet on Submission of Design and As-built Building Information Modelling Data to
Government Building Information Modelling Data Repository,
Lands Department**

Introduction

This information sheet is used for any Government officer's reference who is required to share Building Information Modelling (BIM) data generated from works contracts with the Government BIM Data Repository (GBDR). According to the Development Bureau Technical Circular (Works) No. 2/2021 – "Adoption of Building Information Modelling for Capital Works Projects in Hong Kong", Works Departments (WDs) are required to provide design and as-built BIM models (hereinafter the Models) to the Lands Department (LandsD) for the purpose of facilitating the development of GBDR, which is an important pillar of Smart City Development in Hong Kong. Details of GBDR can be referred to Appendix.

Usages of the Models

Project owner is aware of the following usages of the Models before he/she submitted the Models to GBDR –

- (a) Used by the Government for official application uses, such as logistic planning, works design, city planning;
- (b) Used by Lands Department for updating 3D digital map for Government and public map users;
- (c) Kept by GBDR and related IT sub-systems as a common storage platform.

Exemption

All the Models are required to be submitted to Lands Department, as requested under DEVB TC(W)No. 2/2021 or the latest version. On exceptional grounds, a D2 officer of WDs/Data owner's department may exempt the submission of Models to LandsD. WDs shall appropriately keep records on such decision and inform DEVB of the approvals for exemptions with detailed justifications.

Account Management

Please contact your departmental administrators of GBDR for registering, updating and deleting accounts.

Enquires

Please contact Senior Land Surveyor/Building Information Modelling, LandsD at 2231 3840 or slsbim@landsd.gov.hk



Government BIM Data Repository

Government BIM Data Repository (GBDR) serves as a centralised common data repository for BIM sharing among Lands Department and Works Departments. It stores and shows design and as-built BIM models (hereinafter the Models) in native and open formats for effective and efficient information exchange. The Models provide rich geometric and semantic information for supporting 3D digital map.

GBDR provides a base for orientation, navigation and query for project information. It also provides visualisation of various discipline models such as architectural, structural, mechanical, landscape, etc., in 3D platform. Simplified Models of capital works projects provide information for updating 3D digital map, which model the exterior and interior structures of buildings, infrastructure, site, etc., deriving a digital city from a city landscape to an indoor environment (See Figures 1 & 2).

GBDR can also integrate with different innovative solutions and technologies such as the Internet of Things (IoT), big data analytics, etc., to support applications in space management, traffic impact assessment, environmental impact assessment, etc.



Figure 1: Navigation of Simplified Models at a city landscape

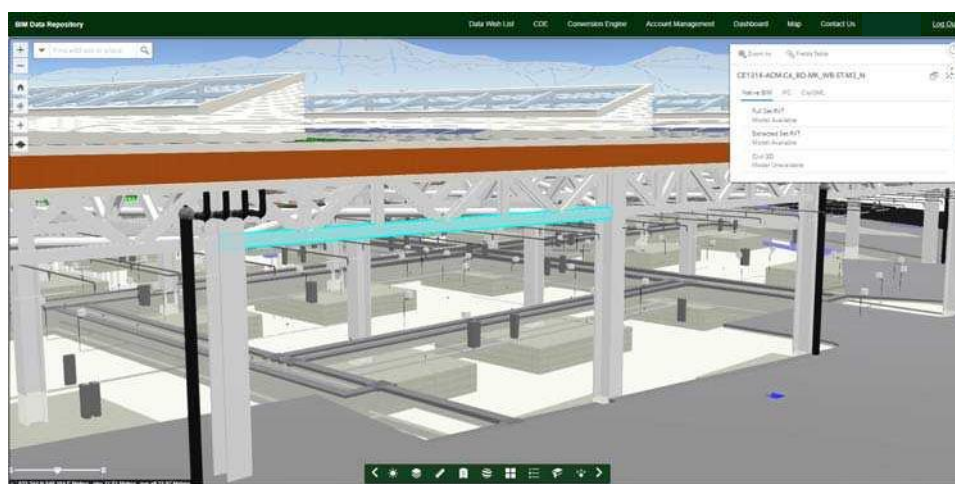

Figure 2: Visualisation of simplified Models in depriving of an indoor environment