

位置 LOCATION

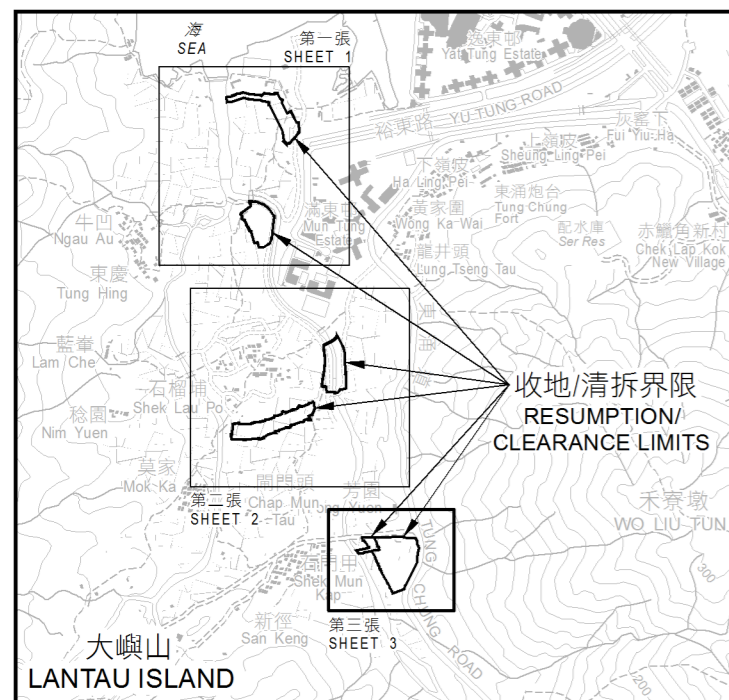

比例 SCALE 1:20 000

圖例 LEGEND

- 收地 / 清拆界限
RESUMPTION / CLEARANCE LIMIT
- 將予收回的土地
LAND TO BE RESUMED
- 地段界線
LOT BOUNDARY
- D.D. 丈量約份
DEMARCATION DISTRICT
- RP 餘段
REMAINING PORTION
- 丈量約份界線
DEMARCATION DISTRICT BOUNDARY
- 橙色
COLOURED ORANGE

說明
NOTE:
有關收地面積表，請參閱第一張
FOR RESUMPTION AREA SCHEDULE, PLEASE REFER TO SHEET 1

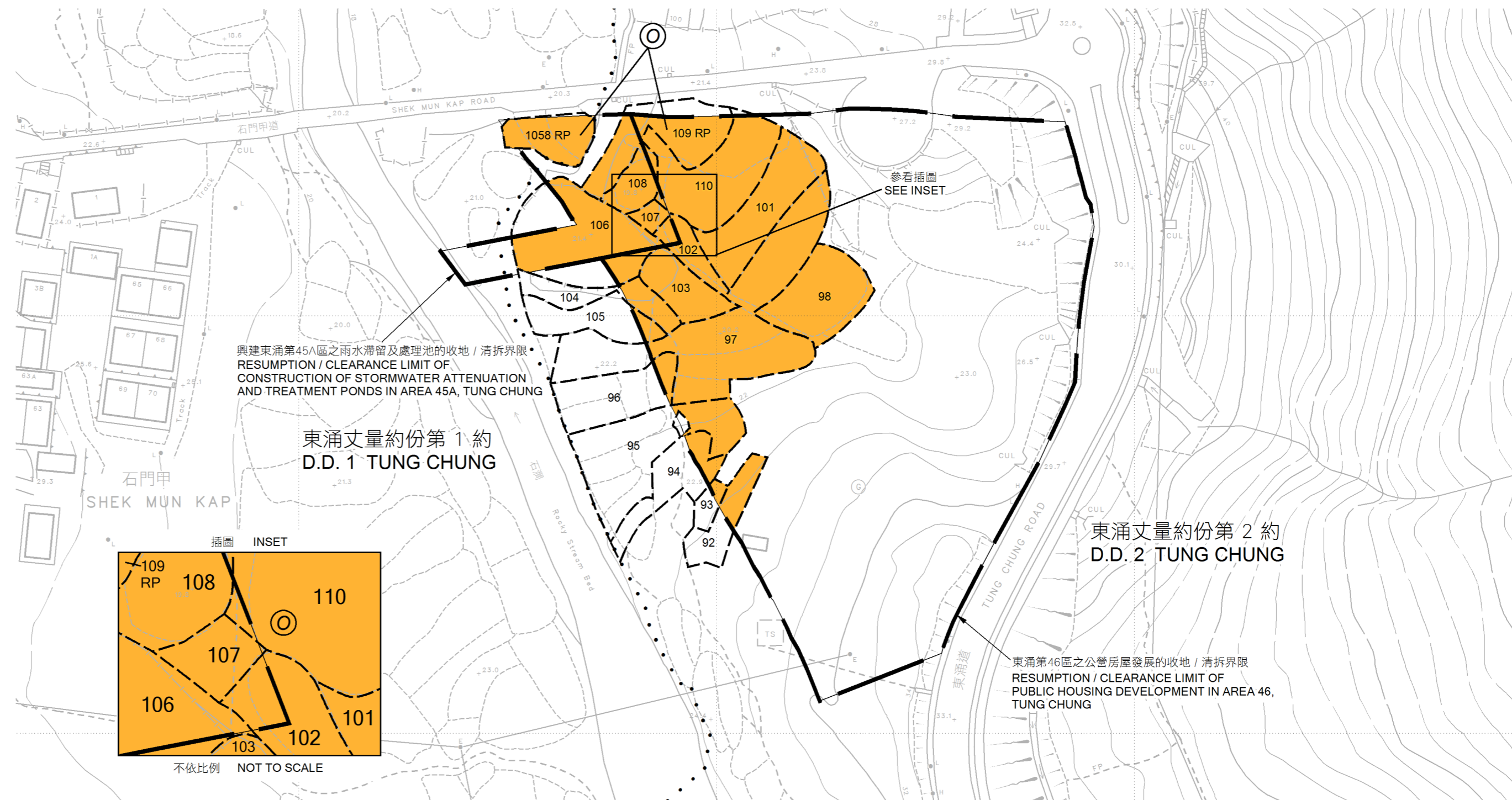

興建東涌第45A區之雨水滯留及處理池的收地 / 清拆界限
RESUMPTION / CLEARANCE LIMIT OF
CONSTRUCTION OF STORMWATER ATTENUATION
AND TREATMENT PONDS IN AREA 45A, TUNG CHUNG

東涌丈量約份第 1 約
D.D. 1 TUNG CHUNG

東涌丈量約份第 2 約
D.D. 2 TUNG CHUNG

東涌第46區之公營房屋發展的收地 / 清拆界限
RESUMPTION / CLEARANCE LIMIT OF
PUBLIC HOUSING DEVELOPMENT IN AREA 46,
TUNG CHUNG

插圖 INSET

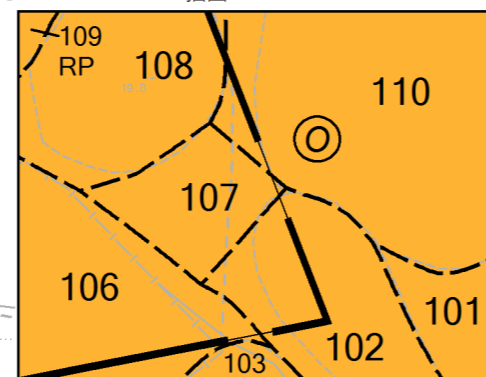

不依比例 NOT TO SCALE

比例尺 SCALE 1:1 000

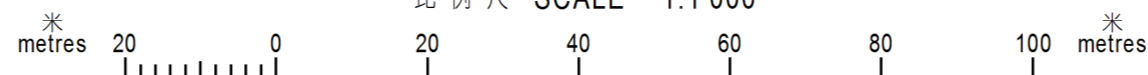

只作識別用
FOR IDENTIFICATION PURPOSES ONLY

已簽署 SIGNED

(黃中偉)(Michael WONG)

署理離島地政專員 District Lands Officer, Islands (Acting)

日期 Date 17 JUN 2021



地政總署 離島地政處
District Lands Office, Islands
Lands Department

圖則由離島測量處繪製
Plan Prepared by District Survey Office, Islands

© 香港特別行政區政府 版權所有 Copyright reserved - Hong Kong SAR Government

收地圖則

收回土地條例 (第124章)

收回土地以便進行東涌新市鎮擴展計劃一

東涌第42、45A、45B、45D、45F及46區之公營房屋發展及其他設施

(東涌第46區之公營房屋發展、興建東涌第45A區、第45B區、第45D區及第45F區之雨水滯留及處理池及
興建東涌近石榴埔河畔公園訪客中心)

RESUMPTION PLAN

LANDS RESUMPTION ORDINANCE (CHAPTER 124)

RESUMPTION OF LAND FOR DEVELOPMENT AT TUNG CHUNG NEW TOWN EXTENSION -

PUBLIC HOUSING DEVELOPMENTS AND OTHER FACILITIES IN AREAS 42, 45A, 45B, 45D, 45F AND 46

(PUBLIC HOUSING DEVELOPMENT IN AREA 46, TUNG CHUNG, CONSTRUCTION OF STORMWATER ATTENUATION AND TREATMENT PONDS IN
AREA 45A, AREA 45B, AREA 45D AND AREA 45F, TUNG CHUNG AND CONSTRUCTION OF VISITOR CENTRE FOR
THE RIVER PARK NEAR SHEK LAU PO, TUNG CHUNG)

LD DLO/IS 10/CRN/2016/K/NLT, LD DLO/IS 15/CRN/2018/K/NLT,
檔案編號 File No. LD DLO/IS 21/CRN/2018/K/NLT, LD DLO/IS 04/CRN/2019/K/NLT &
LD DSO/IS W3878

測量圖編號 Survey Sheet No. 9-SE-13C & D

發展藍圖編號 Layout Plan No. -----

參考圖編號 Reference Plan No. 251854/LR/0701D & 0710C
(土木工程拓展署 CEDD)

圖則編號 PLAN No. ISM3250 (三張的第三張)
(SHEET 3 OF 3)