

位置 LOCATION

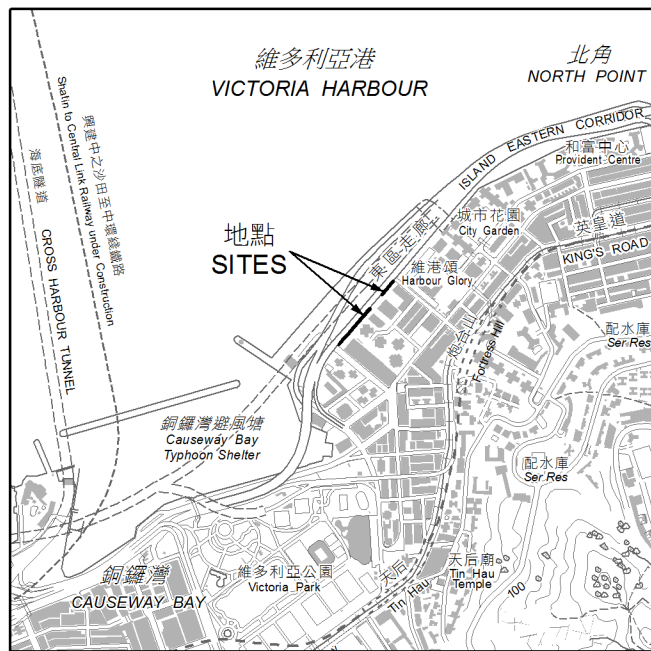

比例 SCALE 1:20 000

維多利亞港
VICTORIA HARBOUR

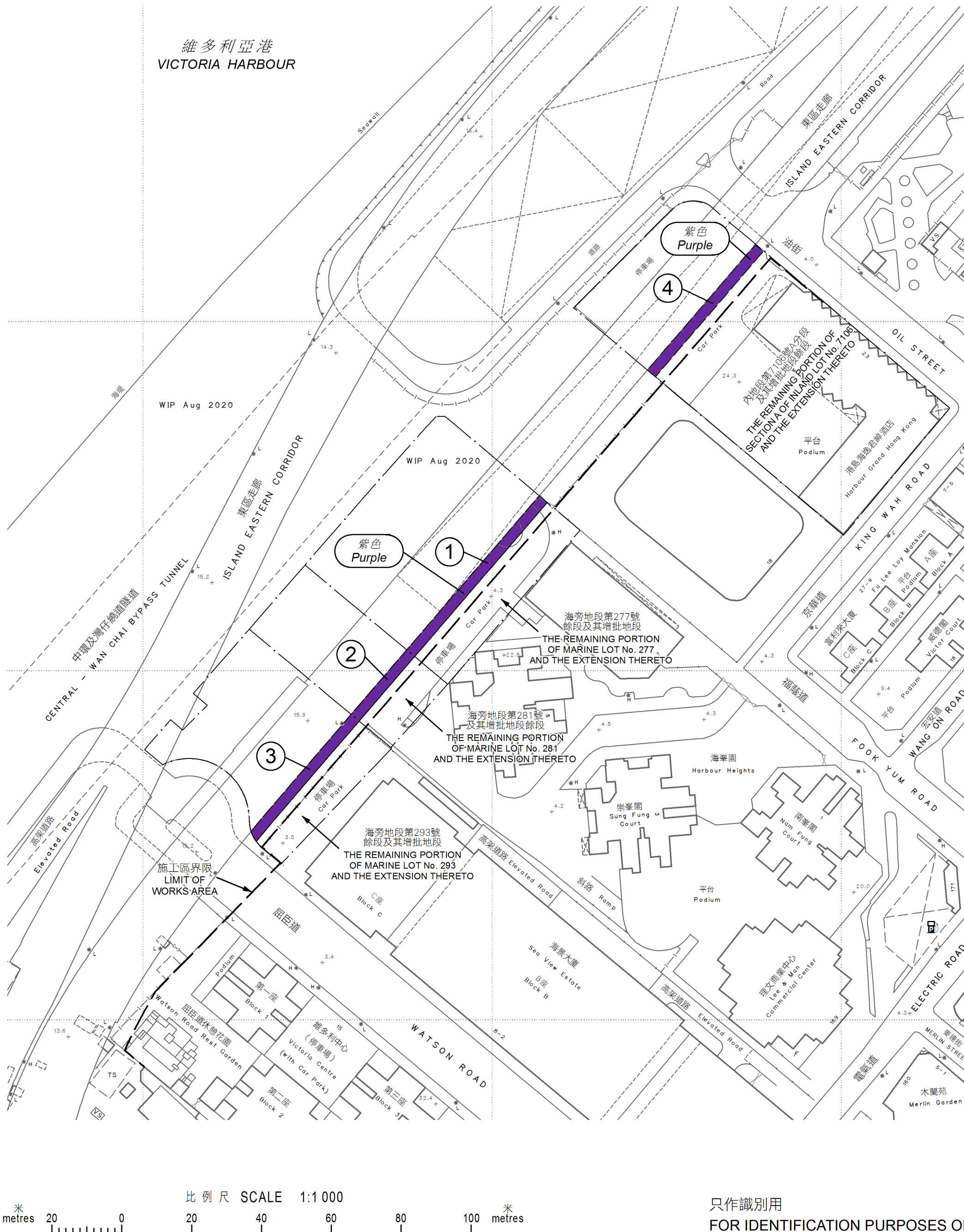

比例尺 SCALE 1:1 000
metres 20 0 20 40 60 80 100 metres

只作識別用
FOR IDENTIFICATION PURPOSES ONLY

設定地役權及永久權利的範圍 AREA FOR CREATION OF EASEMENTS AND PERMANENT RIGHTS		
參考編號 REF. No.	地段編號 LOT No.	面積以平方米計(約數) AREA IN SQUARE METRES (ABOUT)
①	海旁地段第277號餘段及其增批地段的其中一部分土地 A PORTION OF LAND IN THE REMAINING PORTION OF MARINE LOT No. 277 AND THE EXTENSION THERETO	174.7
②	海旁地段第281號及其增批地段餘段的其中一部分土地 A PORTION OF LAND IN THE REMAINING PORTION OF MARINE LOT No. 281 AND THE EXTENSION THERETO	73.1
③	海旁地段第293號餘段及其增批地段的其中一部分土地 A PORTION OF LAND IN THE REMAINING PORTION OF MARINE LOT No. 293 AND THE EXTENSION THERETO	134.9
④	內地地段第7106號A分段及其增批地段餘段的其中一部分土地 A PORTION OF LAND IN THE REMAINING PORTION OF SECTION A OF INLAND LOT No. 7106 AND THE EXTENSION THERETO	141.9

圖例
LEGEND

- 紫色
Purple
- 設定地役權及永久權利的範圍
AREA FOR CREATION OF
EASEMENTS AND PERMANENT RIGHTS

海旁地段第277號餘段及其增批地段、海旁地段第281號及其增批地段餘段、海旁地段第293號餘段及其增批地段及內地地段第7106號A分段及其增批地段餘段的部分土地的地役權及永久權利擬設定於香港主水平基準以上約10米及其上。

EASEMENTS AND PERMANENT RIGHTS IN PORTIONS OF LAND IN THE REMAINING PORTION OF MARINE LOT No. 277 AND THE EXTENSION THERETO, THE REMAINING PORTION OF MARINE LOT No. 281 AND THE EXTENSION THERETO, THE REMAINING PORTION OF MARINE LOT No. 293 AND THE EXTENSION THERETO AND THE REMAINING PORTION OF SECTION A OF INLAND LOT No. 7106 AND THE EXTENSION THERETO ARE PROPOSED TO BE CREATED AT AND ABOVE THE LEVEL OF APPROXIMATELY 10 METRES ABOVE THE HONG KONG PRINCIPAL DATUM.

Signed
(梁妙燕 Karen M. Y. LEUNG)
總地產測量師/土地徵用 Chief Estate Surveyor / Acquisition
日期 Date 16 SEP 2020

設定地役權及永久權利之圖則
道路(工程、使用及補償)條例(第370章)
工務計劃項目第6579TH號中環及灣仔繞道和東區走廊連接路
PLAN FOR CREATION OF EASEMENTS AND PERMANENT RIGHTS
ROADS (WORKS, USE AND COMPENSATION) ORDINANCE (CHAPTER 370)
PWP ITEM NO. 6579TH
CENTRAL - WAN CHAI BYPASS AND ISLAND EASTERN CORRIDOR LINK

檔案編號 File No. ACQ HRS/94/06 & DSO/HK 13/8/1 Pt.2
測量圖編號 Survey Sheet No. 11-SE-6A
發展藍圖編號 Layout Plan No. --
參考圖編號 Reference Plan No. 60095653/SK9003 REV2 (HyD)
圖則編號 PLAN No. HKM10653