

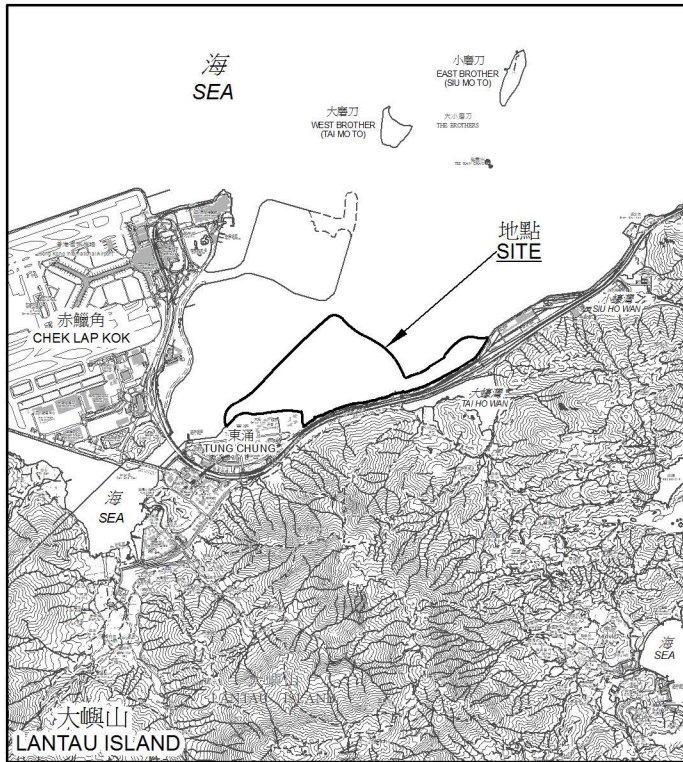

位置 LOCATION



比例 SCALE 1:100 000

圖例 LEGEND

 受影響的前濱及海床範圍
FORESHORE AND SEA-BED AFFECTED

 將進行填海工程的前濱及海床
以闢拓約129公頃土地
FORESHORE AND SEA-BED TO BE RECLAIMED
TO FORM ABOUT 129 HECTARES OF LAND

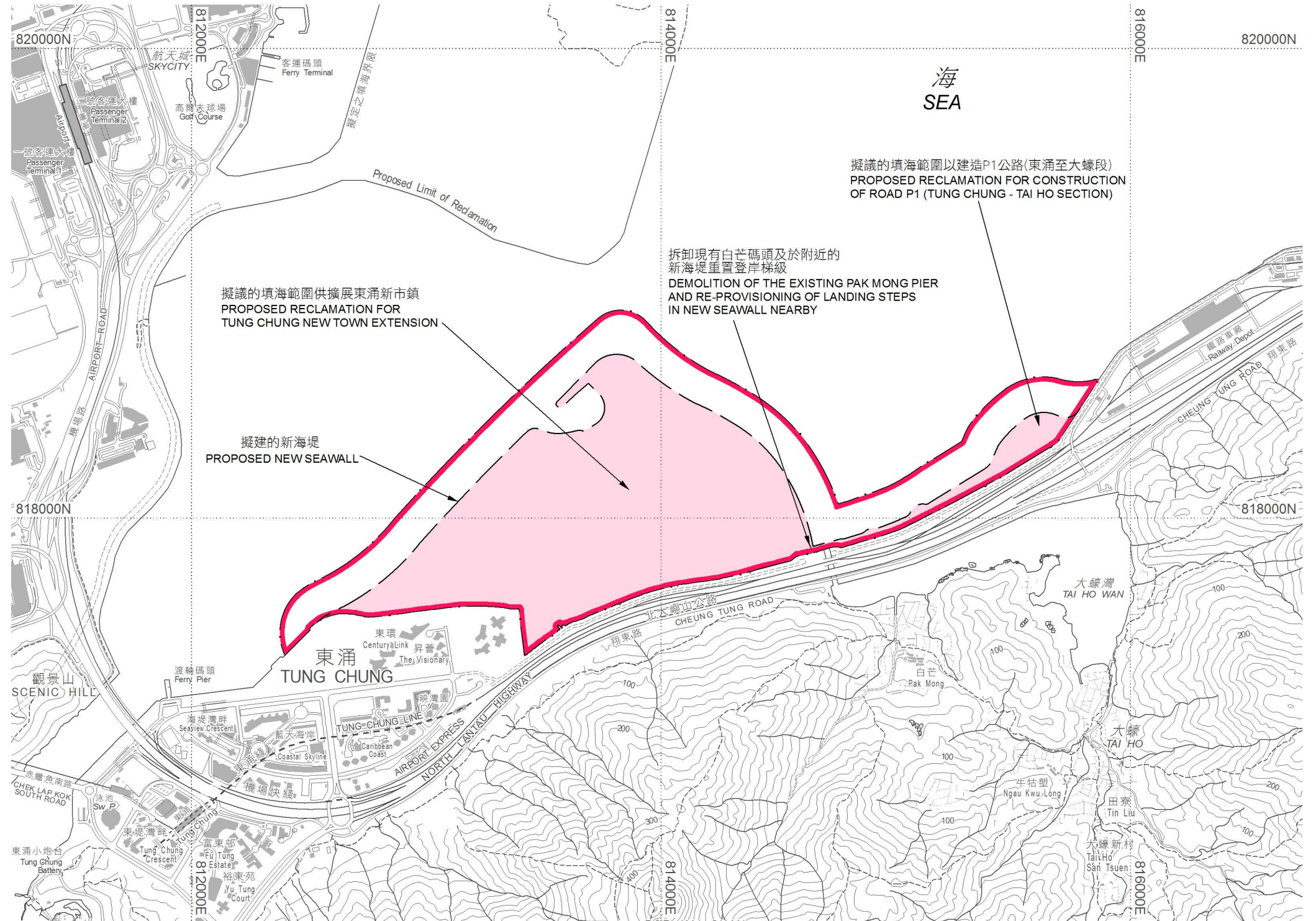

以紅色邊線標示的面積約為 200 公頃 EDGED RED AREA 200 HECTARES (ABOUT)

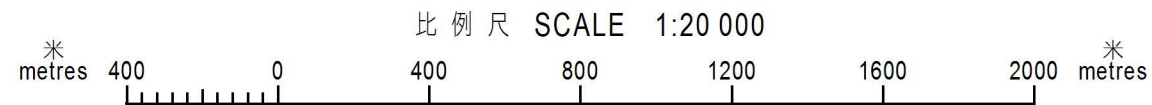

SIGNED
(Olga LAM)
副署長(專業事務) Deputy Director / Specialist
地政總署 30 / 12 / 2015
Lands Department
圖則由離島測量處繪製
Plan Prepared by District Survey Office, Islands
© 香港特別行政區政府 版權所有 Copyright reserved - Hong Kong SAR Government

前濱及海床(填海工程)條例(第127章)
工務計劃項目第7786CL號
東涌新市鎮擴展
FORESHORE AND SEA-BED (RECLAMATIONS) ORDINANCE (CHAPTER 127)
PUBLIC WORKS PROGRAMME ITEM No. 7786CL
TUNG CHUNG NEW TOWN EXTENSION

檔案編號 File No. LD DLO/IS 05/CRN/2015/A/NLT
測量圖編號 Map Sheet No. 9 & 10 (組別 Series HM20C/2)
發展藍圖編號 Layout Plan No. -----
參考圖編號 Reference Plan No. 219844/GZ/005A (CEDD)
圖則編號 PLAN No. ISM2583b