

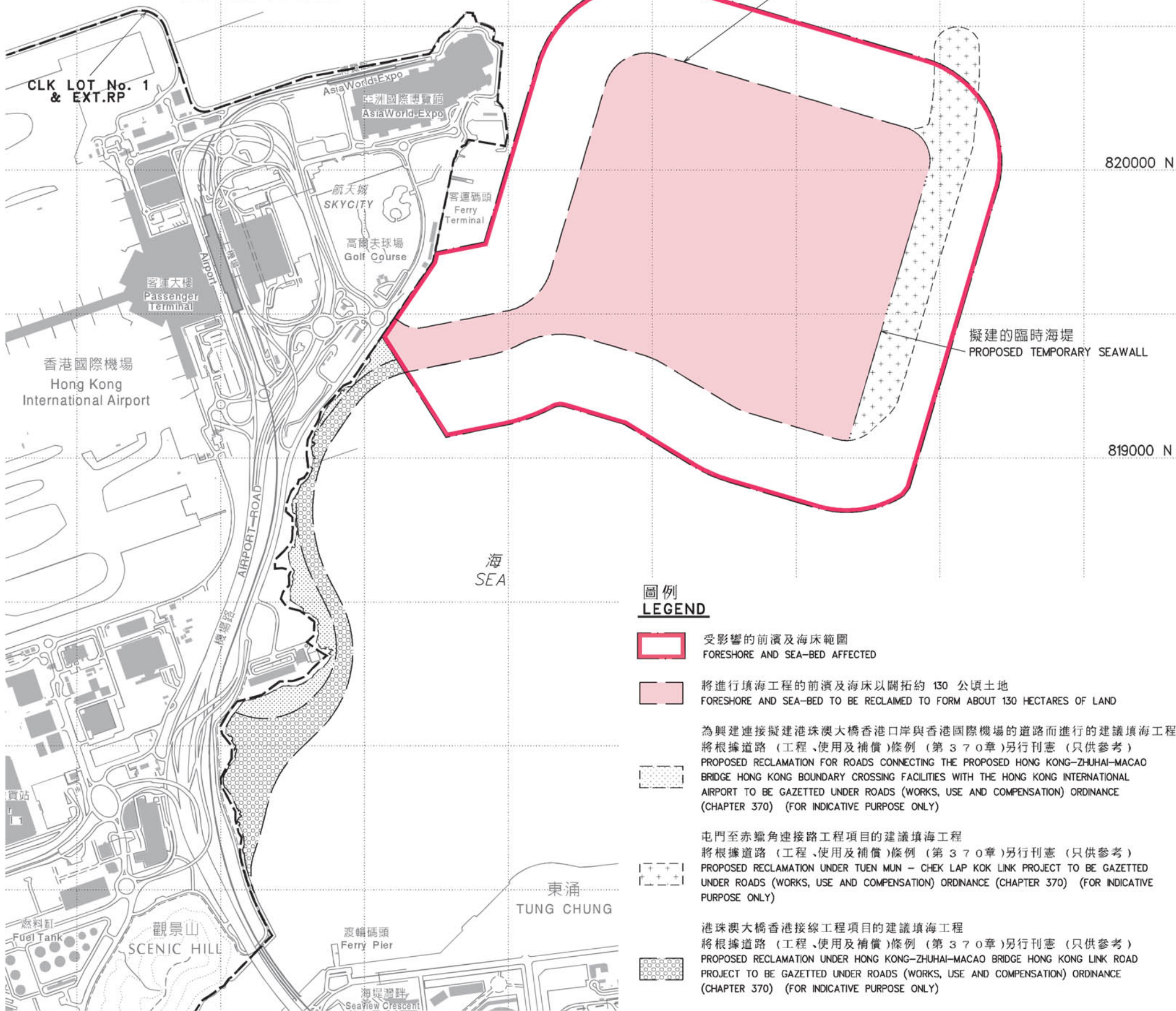





位置 LOCATION



比例 Scale 1 : 80000



圖例 LEGEND

-  受影響的前濱及海床範圍
FORESHORE AND SEA-BED AFFECTED
-  將進行填海工程的前濱及海床以闢拓約 130 公頃土地
FORESHORE AND SEA-BED TO BE RECLAIMED TO FORM ABOUT 130 HECTARES OF LAND
-  為興建連接擬建港珠澳大橋香港口岸與香港國際機場的道路而進行的建議填海工程
將根據道路 (工程、使用及補償) 條例 (第 370 章) 另行刊憲 (只供參考)
PROPOSED RECLAMATION FOR ROADS CONNECTING THE PROPOSED HONG KONG-ZHUHAI-MACAO BRIDGE HONG KONG BOUNDARY CROSSING FACILITIES WITH THE HONG KONG INTERNATIONAL AIRPORT TO BE GAZETTED UNDER ROADS (WORKS, USE AND COMPENSATION) ORDINANCE (CHAPTER 370) (FOR INDICATIVE PURPOSE ONLY)
-  屯門至赤鱗角連接路工程項目的建議填海工程
將根據道路 (工程、使用及補償) 條例 (第 370 章) 另行刊憲 (只供參考)
PROPOSED RECLAMATION UNDER TUEN MUN - CHEK LAP KOK LINK PROJECT TO BE GAZETTED UNDER ROADS (WORKS, USE AND COMPENSATION) ORDINANCE (CHAPTER 370) (FOR INDICATIVE PURPOSE ONLY)
-  港珠澳大橋香港接線工程項目的建議填海工程
將根據道路 (工程、使用及補償) 條例 (第 370 章) 另行刊憲 (只供參考)
PROPOSED RECLAMATION UNDER HONG KONG-ZHUHAI-MACAO BRIDGE HONG KONG LINK ROAD PROJECT TO BE GAZETTED UNDER ROADS (WORKS, USE AND COMPENSATION) ORDINANCE (CHAPTER 370) (FOR INDICATIVE PURPOSE ONLY)

紅邊線標明面積約 267 公頃 EDGED RED AREA 267 HECTARES (ABOUT)

比例尺 Scale 1 : 15000

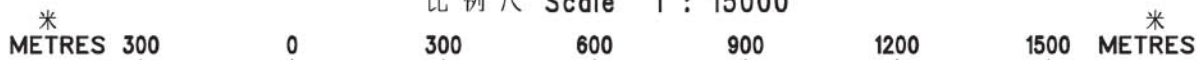

SIGNED

(G M Ross)

副署長 (專業事務)

Deputy Director/Specialist

日期 Date: 10 / 06 / 2009

地政總署 Lands Department

圖則由離島測量處繪製

Plan Prepared by District Survey Office, Islands

前濱及海床 (填海工程) 條例 (第 127 章)

工務計劃項目第 834 TH 號

港珠澳大橋香港口岸

FORESHORE AND SEA-BED (RECLAMATIONS) ORDINANCE (CHAPTER 127)

PUBLIC WORKS PROGRAMME ITEM No. 834TH

HONG KONG - ZHUHAI - MACAO BRIDGE

HONG KONG BOUNDARY CROSSING FACILITIES

檔案編號 File No. LD DS0/IS 13/16/1 Pt.2

測量圖編號 Survey Sheet Nos. 9-NE- A/B

發展藍圖編號 Layout Plan No. -----

參考圖編號 Ref. Plan No. 25308/GZ/001 (HYD)

圖則編號 PLAN No. ISM1711a