

比例 SCALE 1:30000

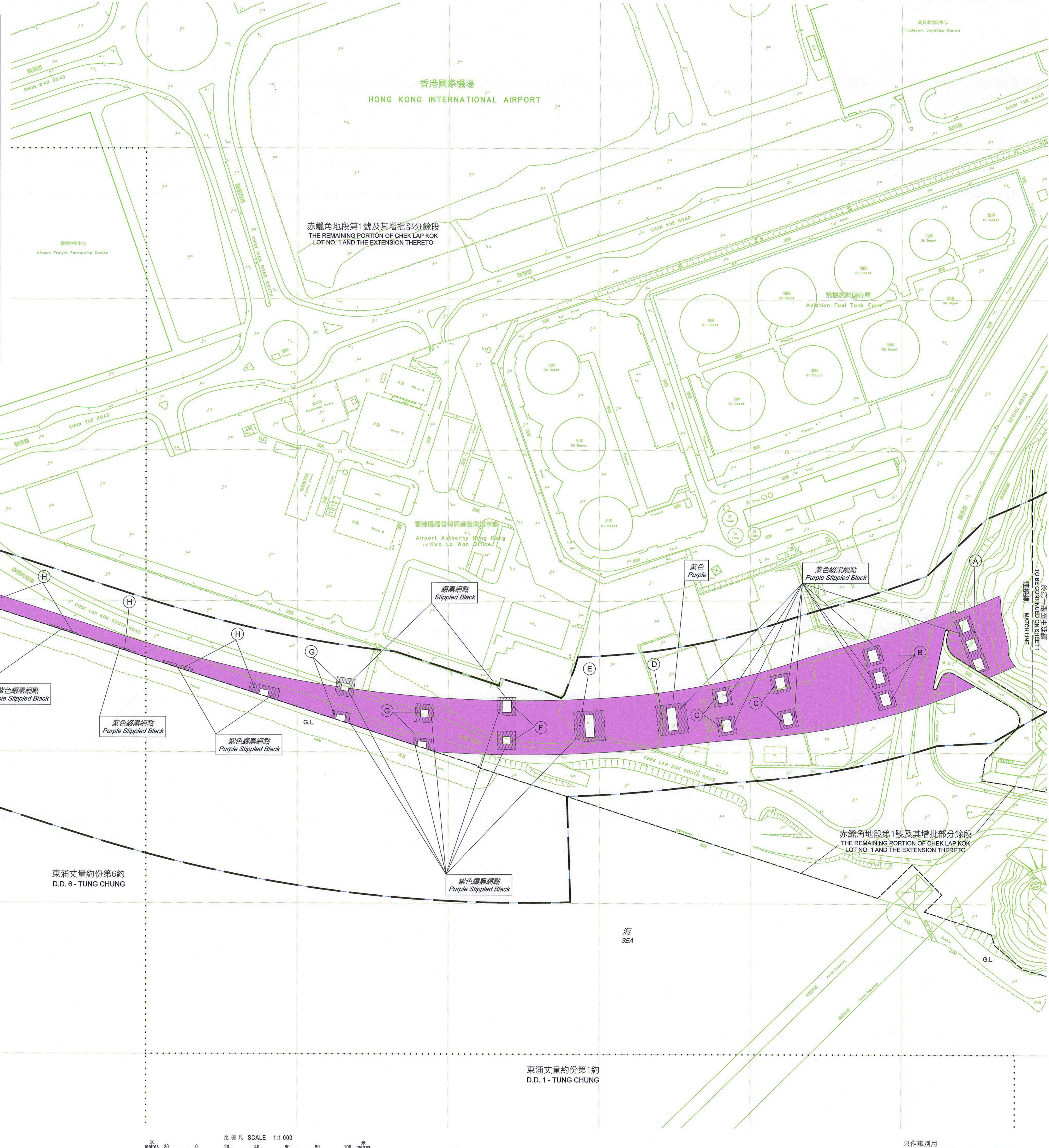

圖例 LEGEND

- 擬於土地之上設定地役權及其他永久權利的赤鱘角地段第1號及其增批部分餘段(部分) (THE REMAINING PORTION OF CHEK LAP KOK LOT NO. 1 AND THE EXTENSION THERETO (PORTION) OVER WHICH EASEMENTS AND OTHER PERMANENT RIGHTS PROPOSED TO BE CREATED (SUCH EASEMENTS AND OTHER PERMANENT RIGHTS ARE PROPOSED TO BE CREATED AT THE APPROXIMATE LEVELS BETWEEN +9.0mHKPD AND +48.0mHKPD))
- 擬於土地之下設定地役權及其他永久權利的赤鱘角地段第1號及其增批部分餘段(部分) (THE REMAINING PORTION OF CHEK LAP KOK LOT NO. 1 AND THE EXTENSION THERETO (PORTION) UNDER WHICH EASEMENTS AND OTHER PERMANENT RIGHTS PROPOSED TO BE CREATED (REFER TO TABLES 1 TO 3 FOR THE APPROXIMATE LEVELS UNDER WHICH EASEMENTS AND OTHER PERMANENT RIGHTS PROPOSED TO BE CREATED (mHKPD)))
- 擬於土地之上設定地役權及其他永久權利的赤鱘角地段第1號及其增批部分餘段(部分) 及擬於土地之下設定地役權及其他永久權利的赤鱘角地段第1號及其增批部分餘段(部分) (THE REMAINING PORTION OF CHEK LAP KOK LOT NO. 1 AND THE EXTENSION THERETO (PORTION) OVER WHICH EASEMENTS AND OTHER PERMANENT RIGHTS PROPOSED TO BE CREATED (SUCH EASEMENTS AND OTHER PERMANENT RIGHTS ARE PROPOSED TO BE CREATED AT THE APPROXIMATE LEVELS BETWEEN +9.0mHKPD AND +48.0mHKPD) AND THE REMAINING PORTION OF CHEK LAP KOK LOT NO. 1 AND THE EXTENSION THERETO (PORTION) UNDER WHICH EASEMENTS AND OTHER PERMANENT RIGHTS PROPOSED TO BE CREATED (REFER TO TABLES 1 TO 3 FOR THE APPROXIMATE LEVELS UNDER WHICH EASEMENTS AND OTHER PERMANENT RIGHTS PROPOSED TO BE CREATED (mHKPD)))
- 地役權界線 LOT BOUNDARY
- 施工區界線 LIMIT OF WORKS AREA
- 鐵路保護界線 RAILWAY PROTECTION BOUNDARY
- 丈量點界線 DEMARCATION DISTRICT BOUNDARY
- D.D. DEMARCATION DISTRICT
- G.L. 政府土地 GOVERNMENT LAND
- HKPD 香港主水平基準 HONG KONG PRINCIPAL DATUM

表 TABLE 2

點 POINT	擬於土地之下設定地役權及其他永久權利的赤鱘角地段第1號及其增批部分餘段(部分) (THE REMAINING PORTION OF CHEK LAP KOK LOT NO. 1 AND THE EXTENSION THERETO (PORTION) UNDER WHICH EASEMENTS AND OTHER PERMANENT RIGHTS PROPOSED TO BE CREATED (mHKPD))
(A)	+6.000
(B)	+6.200
(C)	+5.300
(D)	+5.200
(E)	+5.700
(F)	+6.100
(G)	+5.000
(H)	+0.300

比例尺 SCALE 1:1 000

東涌丈量約份第6約 D.D. 6 - TUNG CHUNG

東涌丈量約份第1約 D.D. 1 - TUNG CHUNG

只作識別用 FOR IDENTIFICATION PURPOSES ONLY

SIGNED
 (曾偉雄 Peter TSANG)
 總地產測量師/土地測量 Chief Estate Surveyor/Acquisition
 日期 Date: 28 / 10 / 2011

設定地役權及其他永久權利圖則
 道路(工程、使用及補償)條例(第370章)
 工務計劃項目第844TH號 港珠澳大橋香港接線
 PLAN FOR CREATION OF EASEMENTS AND OTHER PERMANENT RIGHTS
 ROADS (WORKS, USE AND COMPENSATION) ORDINANCE (CHAPTER 370)
 PWP ITEM No. 844TH HONG KONG - ZHUHAI - MACAO BRIDGE HONG KONG LINK ROAD

檔案編號 File No. MHP 69/HZM/10 PLIV & DSOIS 13/16/1 PL8
 測量圖號 Survey Sheet No. 9-SE-2D & 3C
 發展圖則號 Layout Plan No.
 參考圖則號 Reference Plan No. 214487/LR/112(A) - 113(A) (H/D)
 圖則編號 PLAN No. ISM1742a (合共三張的第二張) (SHEET 2 OF 3)
 日期 Date: 6/10/2011