



圖例

LEGEND

--- 施工區界限  
LIMITS OF WORKS AREA

(R) 將予徵用的土地  
LAND TO BE ACQUIRED

(R) 紅色  
RED

將予徵用土地的面積 AREA OF LAND TO BE ACQUIRED		
地點編號 SITE NO.	墳墓 / 金塔編號 GRAVE / URN NO.	平方米 (約數) m <sup>2</sup> (ABOUT)
地點二 SITE 2	G84	78.1
地點三 SITE 3	G82	65.8
地點四 SITE 4	G83	31.6
地點五 SITE 5	G74	168.5

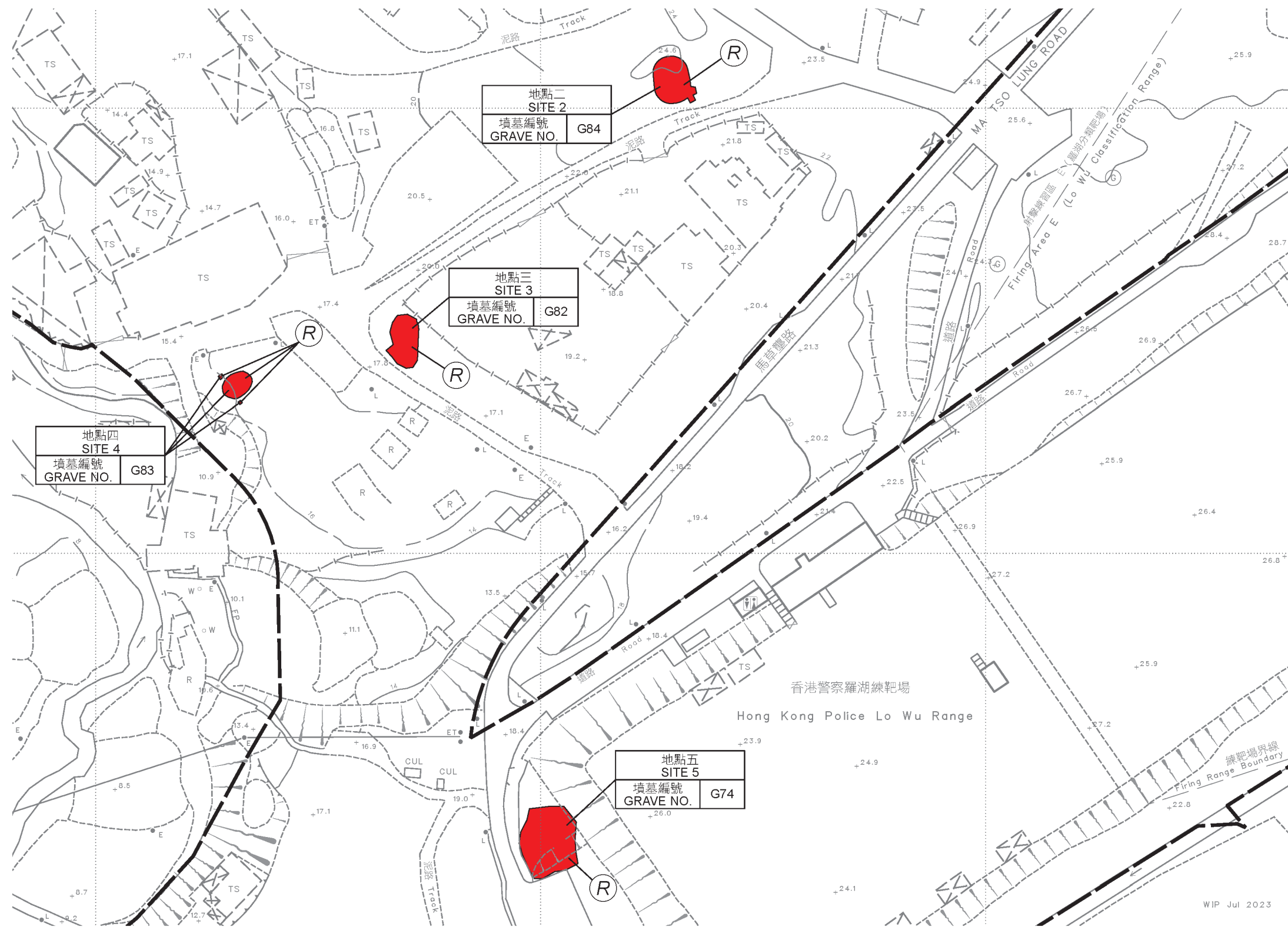

比例尺 SCALE 1:1 000  
 米 metres 20 0 20 40 60 80 100 米 metres

只作識別用  
FOR IDENTIFICATION PURPOSES ONLY

已簽署 Signed  
 (劉燕儀 Joanne LOU)  
 總產業測量師/新發展區 Chief Estate Surveyor / New Development Area  
 日期 Date 10/8/2023

地政總署 新發展區組  
 New Development Area Section  
 Lands Department  
 圖則由測繪處工程項目測量小組繪製  
 Plan Prepared by Projects Survey Unit, Survey and Mapping Office  
 © 香港特別行政區政府 版權所有 Copyright reserved - Hong Kong SAR Government

土地徵用圖則  
 土地徵用(管有業權)條例(第130章)  
 徵用土地以便進行  
 古洞北新發展區及粉嶺北新發展區發展計劃 餘下階段  
 LAND ACQUISITION PLAN  
 LAND ACQUISITION (POSSESSORY TITLE) ORDINANCE (CHAPTER 130)  
 ACQUISITION OF LAND FOR THE DEVELOPMENT OF  
 KWU TUNG NORTH NEW DEVELOPMENT AREA AND FANLING NORTH NEW DEVELOPMENT AREA - REMAINING PHASE

檔案編號 File No.	LD NDA/GRA/3/3/1
測量圖編號 Survey Sheet No.	2-NE-24D & 2-SE-4B
參考圖編號 Ref. Plan No.	5191059-LRP-3000 to 3015, 60624717/G3B/FIGURE 2.1 to 2.13, 60629088/SK1371 to 1379, 5191059/GAZ/1000 to 1011 & 60624717/GAZ/1000 to 1009 (土木工程拓展署) (CEDD)
圖則編號 PLAN No.	DNM5342 (第三張 共十三張) (Sheet 3 of 13)